

Subject:

AMT12 flat belt will break if incorrectly routed.

Issue/Symptoms:

Incorrect routing of the flat belt will result in belt damage making the AMT12 non-functional. When installing/replacing the flat belts on the AMT12, close attention to the routing of the flat belt must be observed. The flat belts that run through the upper arms must be routed OVER the strut location. **See Figure 1.**

Figure 1

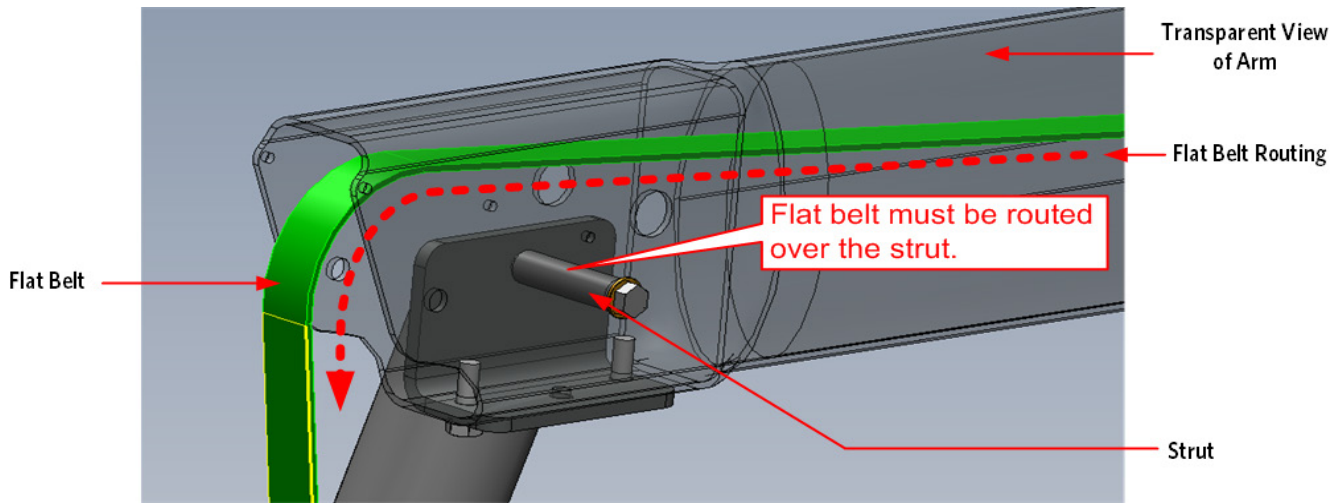

Required Action:

The following procedure describes how to verify that the flat belt has been properly routed over the strut in the upper arm:

1. Remove the four screws that fasten the inside upper arm covers to the upper arm.
2. Remove the screw that fastens the outside upper arm cover to the upper arm.
3. Remove the inside and outside covers from the upper arm. **See Figure 2.**

Figure 2

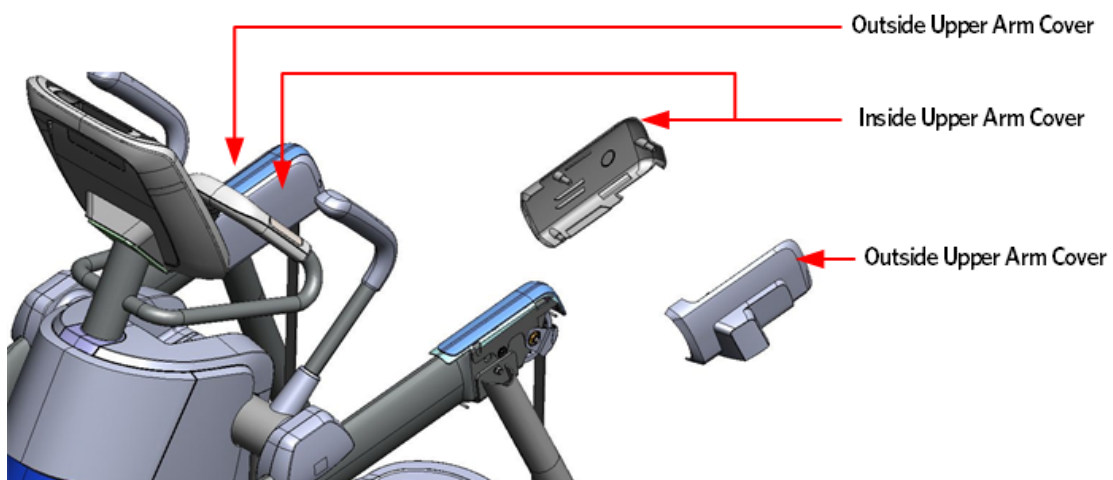

4. Locate the access point on the inside of the upper arm as indicated in **Figure 4**.

Figure 4

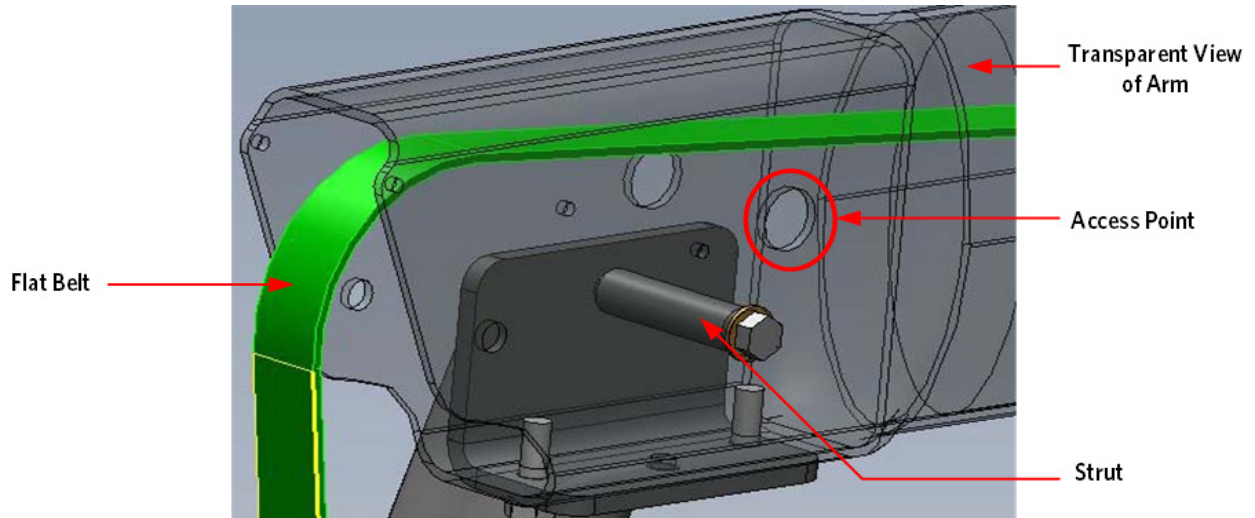

5. Place your finger inside the access point, you should be able to feel the strut within the upper arm.
6. Position your finger so that it can be angled up towards the top of the upper arm and then towards the bottom of the upper arm. If you can feel the flat belt when your finger is angled towards the top of the upper arm, the flat belt is routed **correctly**. If you can feel the flat belt when your finger is angled down towards the bottom of the upper arm, the flat belt is routed **incorrectly** and will need to be re-routed.

Note: When servicing any AMT12, verify proper belt routing through the upper arm using the procedure above.

Please contact **Precor Customer Support** if you have any questions regarding this service bulletin @ 1-800-786-8404.